

HK 125 is a single acting piston seal. Proven sealing abilities of PU groove rings combined with a form closing ring affords high functional reliability even with low total length.

Special Features:

- Two part composition comprising of Polyurethan sealing component and a slit POM sliding ring
- Quick response even at low pressures
- Very good anti wear behavior
- Also usable with single part piston.

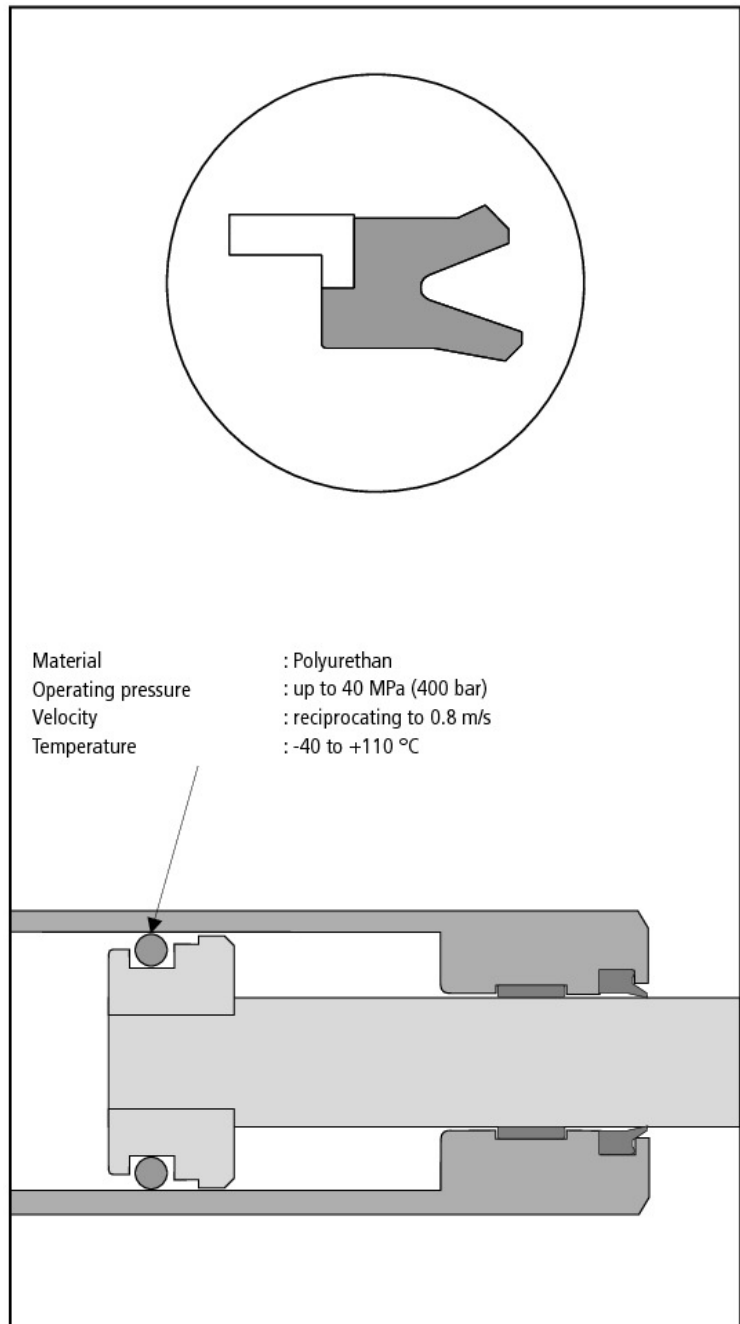

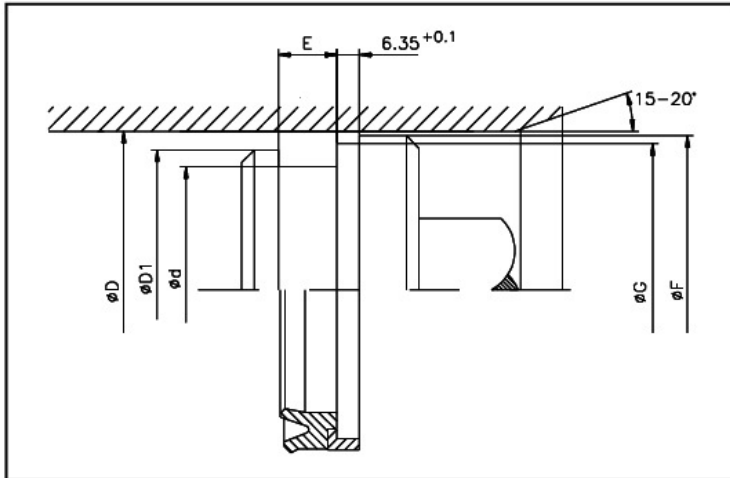

Limitations on Use	
Operating pressure	: up to 40 MPa (400 bar)
Velocity	: reciprocating up to 0.8 m/s
Temperature	: -40 to +110 °C

Media for Use	
Mineral oil based hydraulic oils, Bio Oils as well as flame resistant pressure liquids on request	

Surface Finish		
Urfaces	Rz	Ra
Faces	2,0 µm	0,3 µm
Groove root	6,3 µm	1,6 µm
Groove flanks or sides	10,0 µm	3,2 µm

D H10	d h10	E +0,2	D1	F ±0,1	G h8	Part N°.
32,00	20,00	10,00	25,00	31,40	28,50	HK125 0320-01-200
35,00	22,00	10,00	25,00	34,40	31,40	HK125 0350-01-200
40,00	25,00	9,50	30,00	39,40	35,40	HK125 0400-01-200
40,00	26,00	9,50	30,00	39,40	35,40	HK125 0400-02-200
45,00	30,00	9,50	35,00	44,40	40,40	HK125 0450-01-200
45,00	35,00	9,50	39,00	44,40	40,40	HK125 0450-02-200
50,00	30,00	14,50	35,00	49,40	44,30	HK125 0500-01-200
50,00	35,00	11,00	40,00	49,40	45,35	HK125 0500-02-200
50,00	40,00	11,00	44,00	49,40	45,40	HK125 0500-03-200
55,00	40,00	11,00	45,00	54,40	50,35	HK125 0550-01-200
60,00	40,00	14,50	45,00	59,40	54,20	HK125 0600-01-200
60,00	40,00	14,50	45,00	59,40	55,40	HK125 0600-02-200
60,00	45,00	11,00	50,00	59,40	54,20	HK125 0600-03-200
60,00	45,00	11,00	50,00	59,40	55,40	HK125 0600-04-200
63,00	45,00	11,00	50,00	62,40	58,40	HK125 0630-01-200
65,00	50,00	11,00	55,00	64,40	60,40	HK125 0650-01-200
70,00	50,00	14,50	55,00	69,40	64,20	HK125 0700-01-200
80,00	60,00	13,50	65,00	79,40	74,15	HK125 0800-01-200
80,00	60,00	14,50	65,00	79,40	74,15	HK125 0800-02-200
90,00	70,00	13,00	75,00	89,40	84,15	HK125 0900-01-200
90,00	70,00	14,50	75,00	89,40	84,15	HK125 0900-02-200
100,00	80,00	14,50	85,00	99,40	93,15	HK125 1000-01-200
100,00	80,00	14,50	85,00	99,40	94,15	HK125 1000-02-200
110,00	95,00	13,00	100,00	109,40	103,10	HK125 1100-01-200
120,00	100,00	14,50	105,00	119,40	113,10	HK125 1200-01-200
120,00	100,00	14,50	105,00	119,40	114,10	HK125 1200-02-200

Example for ordering Piston Sea:

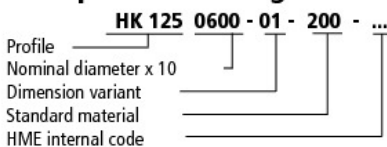

Issue
01 05

WARNING: Limits of application stated herein are standard values. They could be individually transgressed with due consideration to respective service conditions. In the event of a large duty cycle, pulsating operation and other complex operational conditions, simultaneous transgression of these values is not recommended. Due to a large variety of service conditions that may arise in course of a actual use, the company does not take responsibility of or guarantee the functional accuracy of the individual components. Rights for changes are reserved.